

QUICK START GUIDE

TUNE220TWS

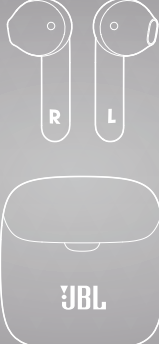

WHAT'S IN THE BOX



HOW TO WEAR

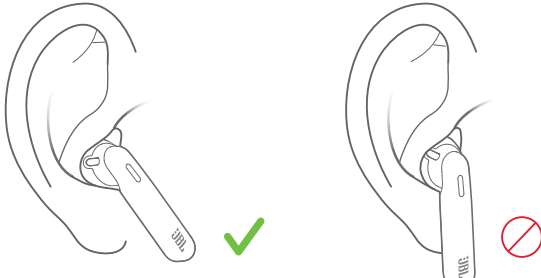

FIRST TIME USE

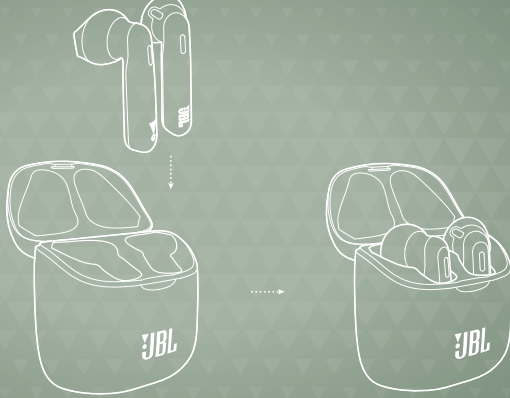

POWER ON & CONNECT

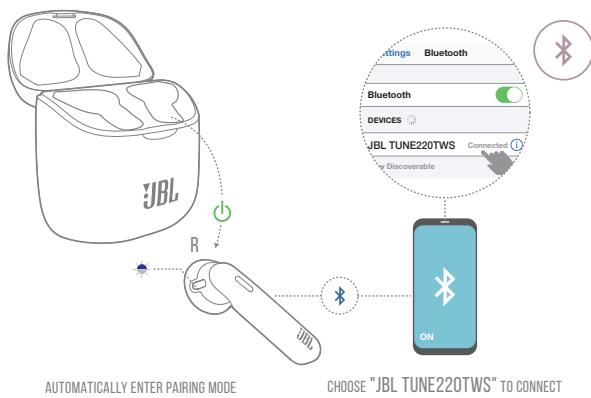

AUTOMATICALLY ENTER PAIRING MODE

CHOOSE "JBL TUNE220TWS" TO CONNECT

PAIRING

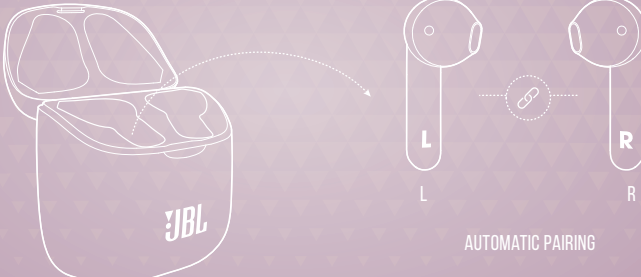

AUTOMATIC PAIRING

POWER OFF

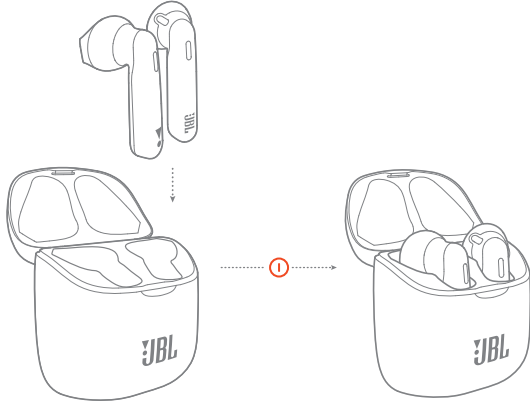

MANUAL CONTROLS

POWER ON & CONNECT TO DEVICE

RECONNECTING LEFT & RIGHT

POWER ON

POWER OFF

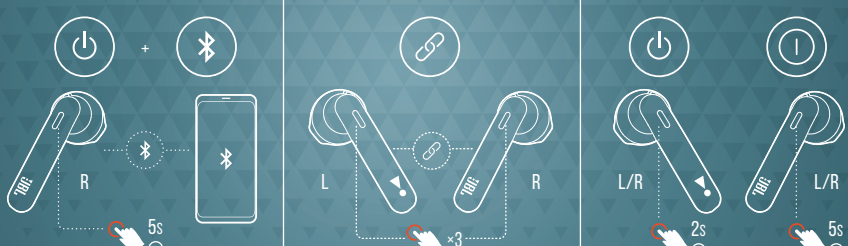

BUTTON COMMAND

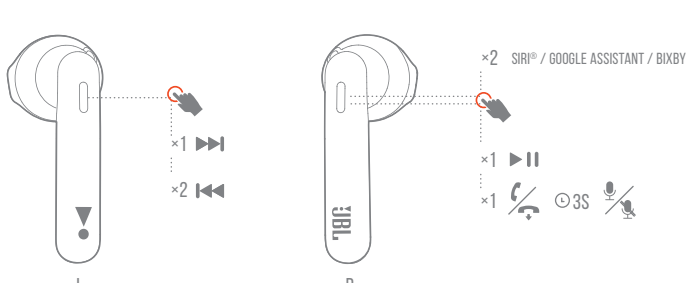

CHARGING

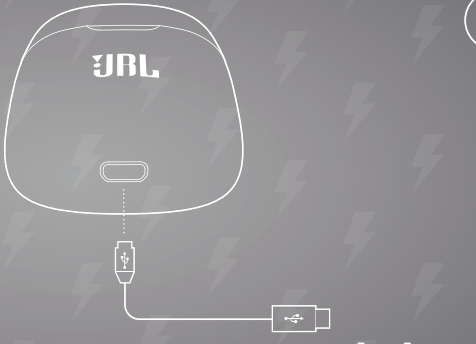

CHARGE

LED BEHAVIORS

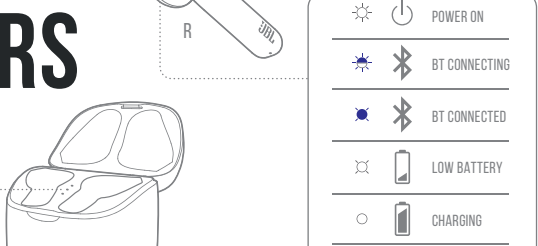
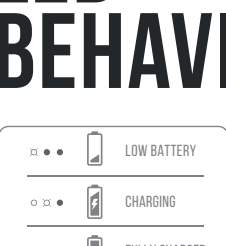

TECH SPEC

Driver Size: 12 mm Dynamic driver
Frequency Response: 20 Hz – 20 kHz
Sensitivity: 105 dB SPL
Maximum SPL: 98 dB SPL
Microphone sensitivity: -30 dBV@1 kHz/Pa
Impedance: 32 ohm
Bluetooth transmitted power: 12 dBm
Bluetooth frequency: GFSK / π/4DQPSK / 8DPSK
Bluetooth profile version: 2.402 GHz – 2.48 GHz
Bluetooth version: A2DP 1.3, AVRCP 1.5, HFP 1.6
Headset battery type: 5.0
Charging case battery type: Lithium-ion battery (22 mAh / 3.85 V)
Power supply: Lithium-ion battery (410 mAh / 3.85 V)
Charging time: 5V === 1.0 A
Music playtime with BT on: <2 hrs from empty
Total music playtime with charging case: 3 hrs
Weight: 19 hrs
57 g



